

Part Number	CD60A-1BE100120	Revision	
Customer P/N		Revision	
Capacitance	100	120	
Voltage	125	VAC	
Dielectric	Aluminum Electrolytic Motor Start		
Terminal Type	Single .187" X .02" Quick Connect Terminals		
Operating Temperature	-25	65 °C.	
Dissipation Factor	0.1	maximum	@ 60 Hz.

# MOTOR Capacitors, Inc.

Motor Capacitors, Inc.  
 335 Beinoris Drive  
 Wood Dale, Illinois 60191  
 773-774-6666 (Phone) | 773-774-6690 (Fax)  
[www.capacitorindustries.com](http://www.capacitorindustries.com)  
[info@capacitorindustries.com](mailto:info@capacitorindustries.com)

	Dimension	Tolerance
Diameter (D)	1.02	0.03
Height (L)	2.76	0.03

*Dimensions in inches*

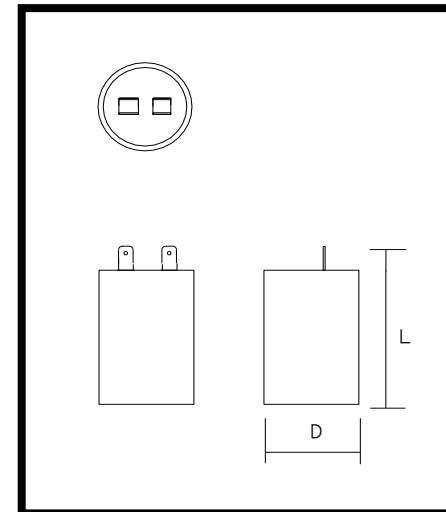

**Stamping**

Motor Capacitors  
 CD60A-1BE100120  
 100-120 uF. 125 VAC  
 Motor Starting Capacitor  
 -25 ~ +65 C.  
 (datecode) RoHS  
 JIS C 4905

**RU** <sup>®</sup> **US**

Aluminum Case

Engineer J.D. Aldana  
 Date May 26, 2009