

# SEI CAPACITORS

SEI Capacitors, Inc.

335 Beinoris Drive, Wood Dale, IL 60191

Phone: 773-774-6666

Fax: 773-774-6690

www.capacitorindustries.com

## CD13L SERIES

Aluminum Electrolytic Capacitors

- Features:
- Long rated life of 5,000 hours at 85 °C
  - High ripple current
  - Used for computers communication power, hi-ripple circuit of electric vehicle, electric train, general-purpose inverter, etc.



### SPECIFICATION

Operating Temperature Range (°C)	-40 ~ +85								
Rated Voltage Range (V)	350 ~ 450								
Nominal Capacitance Range (µF)	1,000 ~ 18,000								
Capacitance Tolerance (20 °C, 120 Hz)	± 20%								
Leakage Current (µA)	$I \leq 0.01CV$ or 5 mA, whichever is smaller (at 20 °C, after 5 minutes) C = Nominal capacitance (µF); V = Rated voltage (V)								
Dissipation Factor (20 °C, 120 Hz)	0.15								
Load Life (+85 °C)	<table border="1"><tbody><tr><td>Time</td><td>5,000 hours</td></tr><tr><td>Leakage Current</td><td>Not more than the initial specified value</td></tr><tr><td>Capacitance Change</td><td>Within ± 20% of the initial value</td></tr><tr><td>Dissipation Factor</td><td>Not more than 200% of the specified value</td></tr></tbody></table>	Time	5,000 hours	Leakage Current	Not more than the initial specified value	Capacitance Change	Within ± 20% of the initial value	Dissipation Factor	Not more than 200% of the specified value
	Time	5,000 hours							
	Leakage Current	Not more than the initial specified value							
	Capacitance Change	Within ± 20% of the initial value							
Dissipation Factor	Not more than 200% of the specified value								
Shelf Life (+85 °C)	<table border="1"><tbody><tr><td>Time</td><td>1,000 hours</td></tr><tr><td>Leakage Current</td><td>Not more than the initial specified value</td></tr><tr><td>Capacitance Change</td><td>Within ± 20% of the initial value</td></tr><tr><td>Dissipation Factor</td><td>Not more than 200% of the specified value</td></tr></tbody></table>	Time	1,000 hours	Leakage Current	Not more than the initial specified value	Capacitance Change	Within ± 20% of the initial value	Dissipation Factor	Not more than 200% of the specified value
	Time	1,000 hours							
	Leakage Current	Not more than the initial specified value							
	Capacitance Change	Within ± 20% of the initial value							
Dissipation Factor	Not more than 200% of the specified value								

# SEI CAPACITORS

*SEI Capacitors, Inc.*

335 Beinoris Drive, Wood Dale, IL 60191

Phone: 773-774-6666

Fax: 773-774-6690

www.capacitorindustries.com

## DIMENSIONS

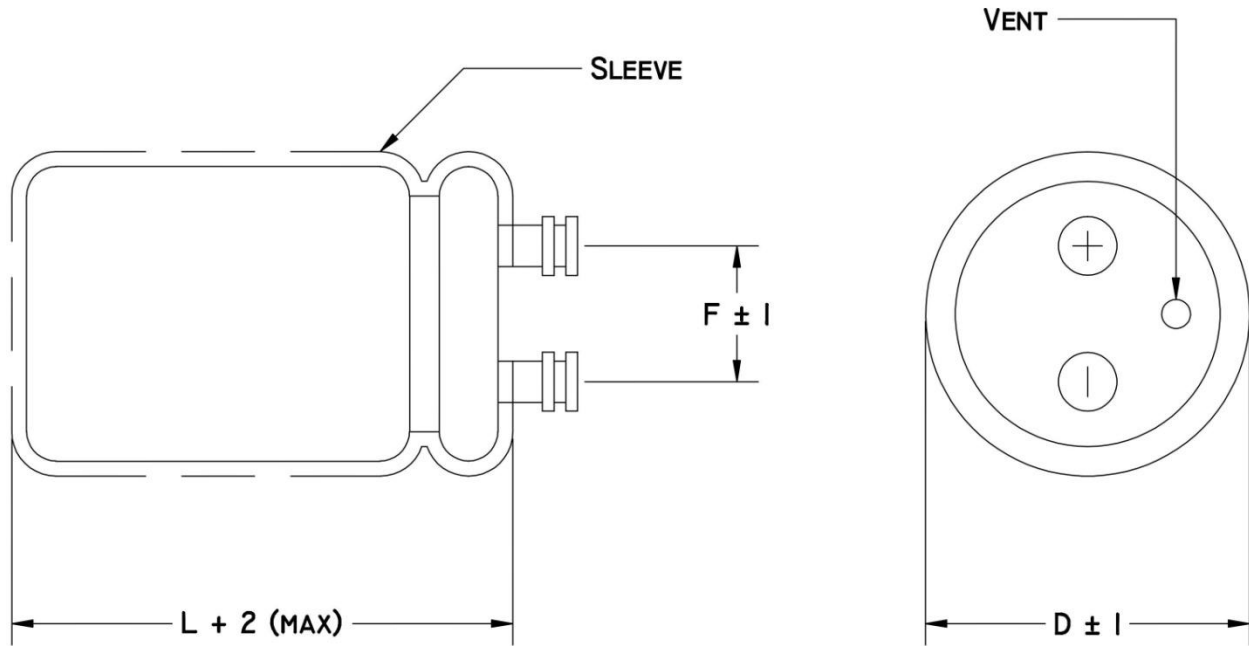

*Dimensions are in millimeters (mm)*

D	51	64	76	89
F	22	28	32	32

## RIPPLE CURRENT MULTIPLIER

Frequency (Hz)	50, 60	120	300	1K	$\geq 10K$
Coefficient	0.7	1.0	1.10	1.30	1.40

*Frequency Coefficient*

Temperature (°C)	+40	+60	+85
Coefficient	1.89	1.67	1.0

*Temperature Coefficient*

# SEI CAPACITORS

*SEI Capacitors, Inc.*

335 Beinoris Drive, Wood Dale, IL 60191

Phone: 773-774-6666

Fax: 773-774-6690

www.capacitorindustries.com

## STANDARD RATINGS

uF \ WV	350		400		450	
	D x L (mm)	Ripple (A)	D x L (mm)	Ripple (A)	D x L (mm)	Ripple (A)
1,000			51 x 83	5.0	51 x 83	5.0
1,200	51 x 83	5.5	51 x 83	5.5	51 x 96	6.0
1,500	51 x 83	6.1	51 x 96	6.7	51 x 115	7.2
1,800	51 x 96	7.4	51 x 96	7.4	51 x 130	8.3
2,200	51 x 96	8.2	51 x 130	9.2	64 x 96	9.0
2,700	51 x 130	10.2	64 x 96	9.9	64 x 115	10.7
3,300	51 x 130	11.3	64 x 115	11.8	64 x 130	12.4
3,900	64 x 115	12.8	64 x 130	13.5	64 x 155	14.5
					77 x 115	13.6
4,700	64 x 130	14.8	64 x 155	15.9	64 x 196	17.5
			77 x 115	14.9	77 x 130	15.6
5,600	64 x 155	17.3	64 x 196	19.1	77 x 155	18.3
	77 x 115	16.3	77 x 130	17.0		
6,800	64 x 196	21.1	77 x 155	20.2	90 x 157	21.4
	77 x 130	18.8				
8,200	77 x 155	22.1	90 x 157	23.5	90 x 157	23.5
10,000	90 x 157	25.9	90 x 157	25.9	90 x 196	28.3
12,000	90 x 157	28.4	90 x 196	31.0	90 x 236	33.6
15,000	90 x 196	34.6	90 x 236	37.5		

Ripple Current: 85 °C, 100 Hz or 120 Hz  
 Specific capacitance and case sizes are available upon request.