

Part Number	<b>CBB65-370R0535</b>	Revision	
Customer P/N	<b>203942-3</b>	Revision	
Capacitance	<b>35 + 5</b>	uF.	Tolerance <b>5%</b>
Voltage	<b>370</b>	VAC	
Dielectric	<b>Metallized Polypropylene</b>		
Terminal Type	<b>.250" Quad-Spade Quick Connect Terminals</b>		
Operating Temperature	<b>-25 oC.-</b>	<b>85 °C.</b>	
Dissipation Factor	<b>0.001</b>	maximum	@ 60 Hz.

# MOTOR Capacitors, Inc.

**Motor Capacitors, Inc.**  
 335 Beinoris Drive  
 Wood Dale, Illinois 60191  
 773-774-6666 (Phone) | 773-774-6690 (Fax)  
[www.capacitorindustries.com](http://www.capacitorindustries.com)  
[info@capacitorindustries.com](mailto:info@capacitorindustries.com)

	Dimension	Tolerance
Case Diameter (D)	<b>1.97/2.07</b>	<b>0.06</b>
Case Height (H)	<b>4.12</b>	<b>0.06</b>
Terminal Height (K)	<b>0.56</b>	<b>ref.</b>
Terminal-Terminal (M)	<b>0.81</b>	<b>ref.</b>
Insulating Cup (dia.)	<b>0.74</b>	

*Dimensions in inches*

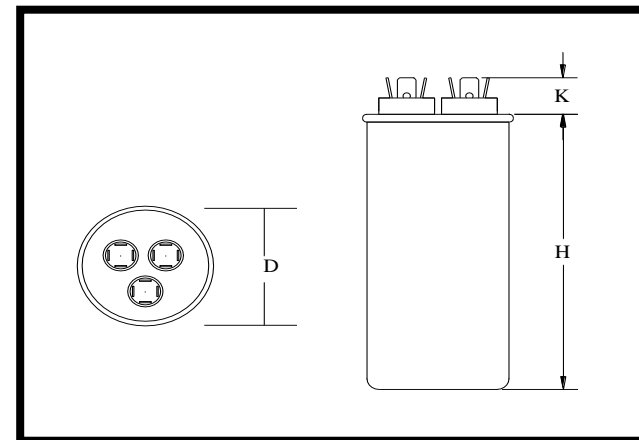

Stamping	<b>Wuxi - Motor Cap</b>			
	<b>CBB65-370R0535</b>			
	<b>35+5uF 5% 370 VAC</b>			
	<b>-25 - +85 C. 50/60 Hz.</b>			
	<b>cRU<sup>®</sup> US</b>			
	<b>Protected 10,000 AFC</b>			
<b>Non PCB</b>	<b>RU</b>	<b>cRU</b>	<b>Date Code</b>	<b>RoHS</b>

**Terminals: Herm (Red-3), Fan (White-1), Common (Black-4)**

Approval: *J.D Aldana*  
 Date: **February 3, 2003**